

# CYCLONE 200

Steerable Wheel Drive



Floor Care



Mobile Robots & AGVs



Material Handling

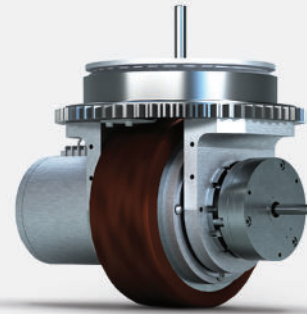

## FEATURES

**Sealed drive system:** Rugged, compact

**Optional components:** Electromagnetic power-off brake, encoders, connectors, brake cover, IP67 conformity

**Voltage:** 48V DC

**Wheel:** Integral 7.9 in [200 mm] diameter

**Gear set:** Helical compound planetary

**Brake options available:** Up to 12 Nm

## PERFORMANCE EXAMPLE

Sample Application Data			
Maximum Wheel Load	1,500 lbs [680kg]	Motor Type	BLDC with Hall Effects Board
Maximum Grade	7%	Reduction Ratio	20:1
Minimum Speed on Level Ground	393 ft/min [2.0 m/s]	Power Consumption on Level Ground	0.30 kW
Minimum Speed on Grade	300 ft/min [1.5 m/s]	Power Consumption on 7% Grade	1.47 kW

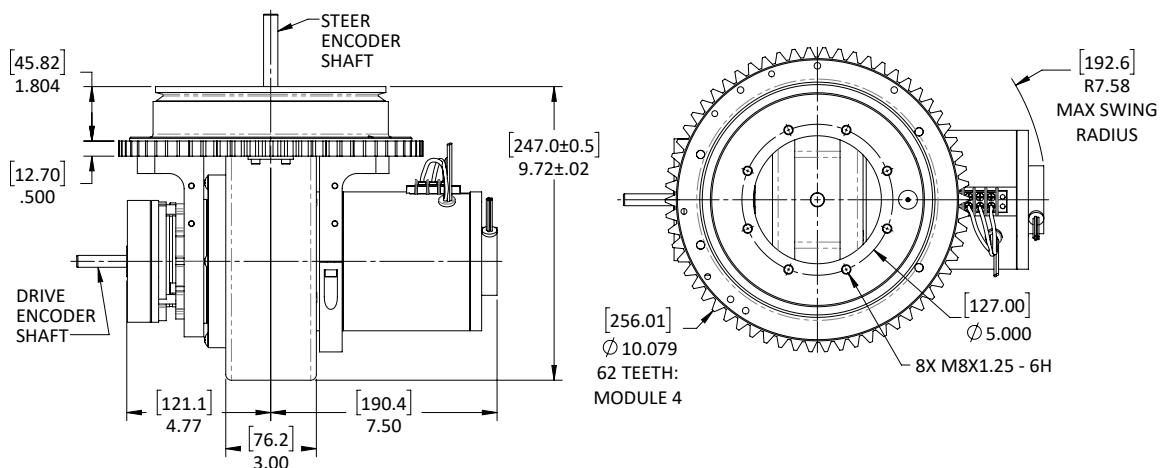



RESULTS.  
DRIVEN.

Lasting solutions to drive your machines. More than industrial designers and engineers, we're a team of passionate problem solvers. ASI Drives: Gear drive systems for battery powered machines up to one ton.

# OUR CUSTOMERS HAVE BEEN WITH US FOR OVER **15 YEARS ON AVERAGE BECAUSE OF OUR:**

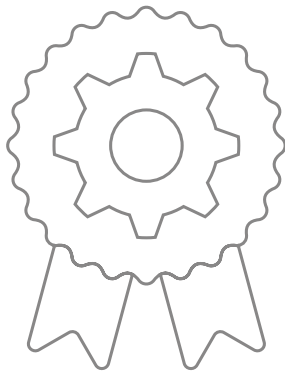

## DEEP EXPERTISE:

Creating over 740 tailored engineered solutions

Offering cost sensitive designs with manufacturing efficiencies

A history of innovation recognized with 7 awarded patents

In-house gear manufacturing offers supply chain predictability



## OUR 40-YEAR COMMITMENT:

Excellent customer service

"Best in class" partnership with OEM industry leaders

Our entrepreneurial size ensures personal executive level accountability and responsiveness



## DEEP INDUSTRY KNOWLEDGE & FOCUS:

Insights and solutions to your specific challenges & opportunities

We know your competitive landscape

**EXPERIENCE THE DIFFERENCE OUR DEDICATION TO INNOVATION, QUALITY AND SERVICE MAKES.**

Contact us at [sales@asidrives.com](mailto:sales@asidrives.com) to explore how we can quickly solve your most pressing challenges.

